



M-LS

DIMENSIONS

Width : 1200mm, 1500mm, 1800mm

Depth : 600mm, 800mm

Height : 750mm

DETAILS

- Table Top made of 24 mm MDF with CPL lamination, PVC edging
- Base Legs Die-casted Aluminium Alloy finish chrome
- Column Legs & Beam Aluminium Extrusion 1.8mm finish baking vaernish
- Column Cover Plastic / PP Black color
- Bracket Aluminium Extrusion 1.8mm finish baking vaernish
- Castors made of PU material, with a size of 2.5 inches, 2 Castor units are equipped with a mechanism, lock (LOCKABLE CASTOR)

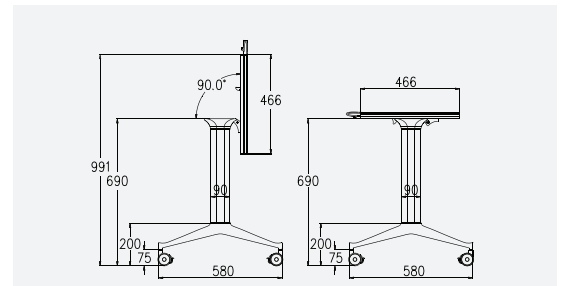

FIRM is a furniture brand by Malka.

Actual color may differ from printed color.

All specifications are subject to change without prior notice.

F I R M

malka

www.malka.co.id